

www.naild.it



Quick reference guide only. Avoid accidents. Read and strictly follow complete manual on back and at www.naild.it



Quick GUIDE to be removed by user only

QUICK GUIDE



INSTALL AXLE

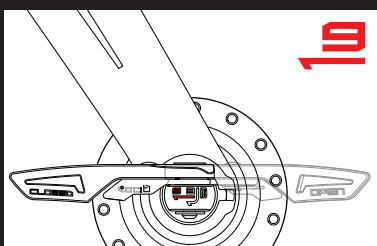
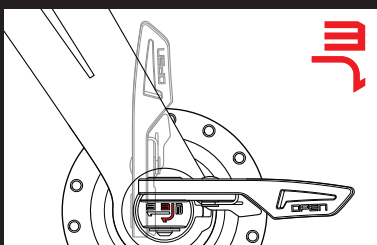
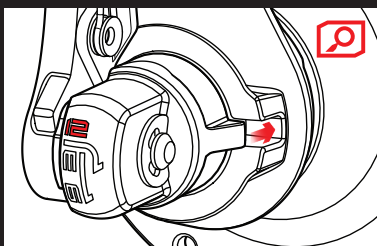
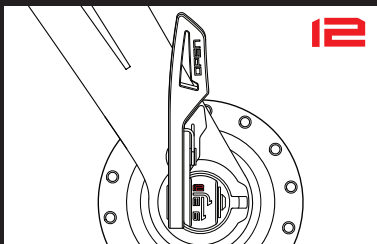

www.naild.it



REMOVE AXLE

QUICK GUIDE

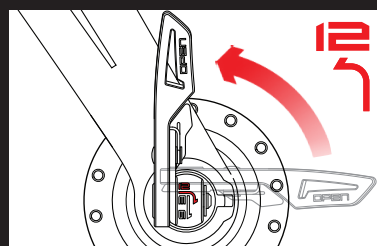
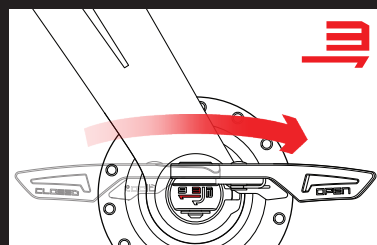
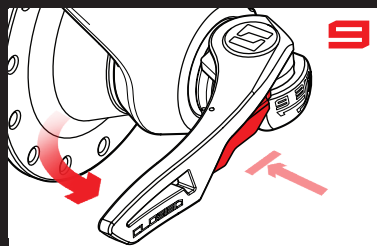
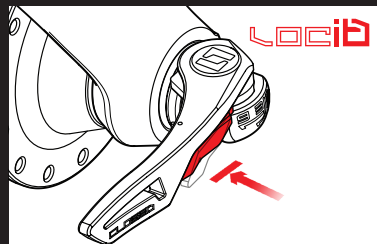

GENERAL NOTICE

⚠ WARNING: BEFORE USING THIS PRODUCT, READ, UNDERSTAND AND FOLLOW THE WARNINGS AND INSTRUCTIONS PROVIDED IN THIS MANUAL. IMPROPER INSTALLATION CAN RESULT IN SEVERE PERSONAL INJURY OR DEATH.

If you have any questions, contact the place of purchase, or a bicycle dealer. A dealer's manual for professional and experienced bicycle mechanics is available on our website (www.naild.it).

Never use tools to operate the 12-3-9® system as damage may occur. Hand pressure is all that is needed.

Do not disassemble or alter this product.

Products are not guaranteed against natural wear or deterioration from normal use and aging. See www.naild.it for warranty terms and conditions.

For maximum performance timely and appropriate service is mandatory. If unclear whether the product is in need of service or repair, contact the place of purchase or a bicycle dealer.

QUADRANT CODE SYSTEM

The Naild 12-3-9® system employs the Quadrant Code System to provide a quick visual reference to the appropriate use, warranty period, durability and recommended service intervals. Please refer to the markings on your product in reference to the Quadrants shown herein.



Category of Use (C)- the type of riding the product was intended for on a scale of 1 through 9 with 1 being light recreational use and 9 being downhill or freeride use.

Warranty Period (W)- warranty period in months.

Durability Index (D)- level of expected durability where a higher number indicates a greater margin of strength and durability within a given usage category.

Service Interval (S)- recommended service interval in hours, e.g., 20 would indicate that the product should be serviced every 20 hours of riding time.

Regularly clean and inspect your 12-3-9® system for wear or damage. For example, lubricating the inside of the **Axle Assembly** with a high quality, waterproof grease will help ensure top performance and extend the life of the parts. If you are unsure how to clean and inspect your 12-3-9® system take it to your place of purchase or a qualified bicycle dealer.

The 12-3-9® system carries a 36 months warranty on parts and assembly. See www.naild.it for warranty terms and conditions. A few things to note will help extend the life of the system and ensure years of trouble-free riding. Never force the system to open or close. Never use anything other than hand pressure to operate the system, no tools are ever required. Depressing the **Locit®** trigger until it has fully disengaged from the lever will prolong its life.

GENERAL SAFETY GUIDELINES

⚠ WARNING: BEFORE USING THIS PRODUCT, READ, UNDERSTAND AND FOLLOW THE WARNINGS AND INSTRUCTIONS PROVIDED IN THIS MANUAL. IMPROPER INSTALLATION CAN RESULT IN SEVERE PERSONAL INJURY OR DEATH.

The 12-3-9® system requires specific features that are integral to the frame and fork for proper use of the system. Never use the 12-3-9® system on non-compatible frames and forks. For a list of compatible frames and forks please visit www.naild.it

The 12-3-9® system is not compatible with some hub designs. Do not attempt to use the 12-3-9® system with non-compatible hubs. For a list of compatible hubs please visit www.naild.it.

EVERY TIME YOU RIDE

⚠ WARNING: Clamping forces should be checked before every ride and any time the wheel is removed and reinstalled. Before attempting to install the 12-3-9® system always inspect all surfaces to make sure they are clean and free from debris and other matter that would prevent full engagement.

The 12-3-9® system has been carefully engineered to be easy and intuitive to set up and use. Once set up properly and maintained according to the instructions in this manual the 12-3-9® system is very stable and should require very little adjustment. However, the following safety guidelines should always be observed to ensure your 12-3-9® equipped bike is safe and ready to ride.

Always check your 12-3-9® system before riding to make sure that the wheels are correctly installed on the bicycle frame. See www.naild.it for warranty terms and conditions. Make sure that the 12-3-9® system levers are in the CLOSED position with the Locit® trigger fully engaged and the CLOSED inscription on the end of the lever visible.

Lift up the bicycle so that the wheel is off the ground, and give the top of the tire a few sharp downward blows as shown in the diagram. The wheel should not be loose or come off. Also check for side-to-side play and make sure the disc rotors are properly aligned and not rubbing. If the rotor is rubbing then open the 12-3-9® system and make sure that everything is clean and properly adjusted and try again.

A misaligned rotor can cause the brakes to fail resulting in severe personal injury or death. If you are unsure how to properly align your brake rotors take the bike to a dealer or qualified bicycle mechanic.

These checks do not guarantee that the quick release lever has received adequate tightening torque. If you are uncertain as to whether the 12-3-9® system is tightened correctly, repeat the INSTALL AXLE AND ADJUSTMENT section of this guide.

AXLE INSERTION

⚠ WARNING: Before using this Product, read, understand and follow the warnings and instructions provided in this manual. Improper installation can result in severe personal injury or death.

***Note:** The bike should be in a normal, horizontal position

***Note:** Before attempting to install the Axle Assembly inspect all surfaces and make sure they are clean and free from debris and other matter that would prevent full engagement.

- If installing for the first time, rotate the Adjuster Cap counter clockwise until strong resistance is felt.
- With the lever positioned at 12 and the Clocking Tooth at 3 insert the Axle Assembly through the frame/fork and into the hub ensuring the **Clocking Tooth** engages with the slot in the fork/frame. There should be little to no resistance.
- If the sides of the **Clocking Tooth** do not engage the sides of the locating slot in the frame/fork that means the **Axle Assembly** is not inserted far enough into the **Adjuster Assembly**. To remedy this, rotate the **Adjuster Cap** clockwise until the **Clocking Tooth** engages the sides of the slot but not quite touching the bottom of the slot.

⚠ WARNING: Do not rotate the Adjuster Cap so that the Axle Assembly becomes tight against the frame/fork. This will create too much clamping force and may cause damage, resulting in an accident, personal injury and death.

'12' TO '3'

- With the axle properly inserted and the **Clocking Tooth** touching the sides of the locating slot. The lever assembly should not be tight against the frame/fork yet. The lever is now free to rotate clockwise from **12** to **3** smoothly with little resistance.

⚠ WARNING: The lever will not rotate unless the axle insertion procedure was followed exactly. Do NOT force the lever to rotate or damage may occur resulting in an accident, personal injury and death.

- With the lever in the **3** position the **Axle Assembly** should now be engaged with **Adjuster Assembly**. Please note that the **Axle Assembly** cannot be removed at this point without rotating the lever back to **12**. Also, the **12-3-9°** system is not fully closed yet and will feel loose.

'3' TO 'PARALLEL'

- From the **3** position, flip the lever halfway so that it is pointing straight out. **Parallel** to the axle. There should still be very little tension on the lever at this point. You are now ready to set the pre-adjustment tension.

⚠ WARNING: Do not flip the lever to the **9** position yet. If the lever is accidentally flipped to the **9** position please refer to the REMOVE AXLE ASSEMBLY section or damage may occur, resulting in an accident, personal injury and death.

TENSION PRE-ADJUSTMENT

- With the lever in the **Parallel** position, rotate the **Adjuster Cap** clockwise until you feel firm resistance. This will indicate that the **Axle Assembly** is fully inserted through the frame/fork and hub and is properly engaged with the **Adjuster Assembly**. The system is ready to be closed.



'PARALLEL' TO '9'

- Flip the lever from **Parallel** to the **9** position, feeling for increasing resistance. Do not touch the **Locit®** trigger during this motion. If the resistance is too great to close the lever completely so that the **Locit®** trigger engages, return the lever to the **Parallel** position and rotate the **Adjuster Cap** counter clockwise a few clicks and try again. Similarly, if the lever feels too loose in the **9** position, depress the **Locit®** trigger and return the lever to the **Parallel** position, rotate the **Adjuster Cap** clockwise a few clicks and move the lever to the **9** position until the **Locit®** trigger clicks. A little back and forth adjustment may be required to properly dial in the clamping force.

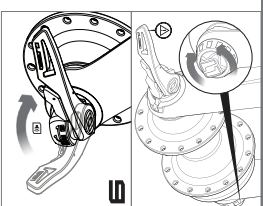

⚠ WARNING: Do not force the lever or damage may occur. Only hand pressure should be used. Never use tools to close the lever. Before riding, check that the axle system is completely engaged as per the General Safety Guidelines.

- Lever torque specification in the CLOSED position is 5.0 – 7.5 N.m (44-66 in.-lb)
- There will be an audible click as the **Locit®** trigger engages and the CLOSED inscription will be clearly visible at the end of the lever. The lever now cannot be opened without first depressing the **Locit®** trigger.
- Before riding, check that the axle system is completely engaged as per the General Safety Guidelines.

REMOVE AXLE

'9' TO '3'

- First, fully depress **Locit®** trigger.
- While still depressing the **Locit®** trigger, flip the lever open from **9** to **3** position. Do not force the lever. It will not open unless the **Locit®** trigger is first fully depressed



'3' TO '12'

- Once in the **3** position the lever can now be rotated counter clockwise to the **12** position.
- From the **12** position, the **Axle Assembly** is now disengaged from the **Adjuster Assembly** and can be slid out to remove the wheel.

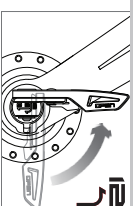

GLOSSARY OF TERMS

⚠ WARNING:

Please read and understand these terms before installing and using the **12-3-9°** system.

12-3-9° SYSTEM LOCATION

The **12-3-9°** system is located on the front and/or rear hub of your bicycle. The hub is located at the center of each wheel.



12-3-9°

References the hand positions of a clock, (i.e., **12** is the 12 o'clock position, **3** is the 3 o'clock position and **9** is the 9 o'clock position.)



Axle Assembly

The complete axle assembly including the lever with **Locit®** trigger, **Clocking Tooth**, and axle.



Clocking Tooth

A small locating tab on the axle assembly that, when properly engaged in the corresponding slot in the frame or fork, ensures the lever position references the **12-3-9** clock positions.



Adjuster Assembly

The part of the **12-3-9°** system that is permanently fixed to the frame or fork including the **Adjuster Cap** which adjusts, sets and retains the proper clamping forces.

Parallel
The parallel position is with the lever pointing straight out, or parallel to the axle.



Locit®

The small, spring-loaded red trigger on the lever that prevents the lever from opening unless depressed.

